

## BRUNNER SYSTEM MASONRY HEATERS



### BSG 01 with MSS

### for GOT 51/67-ZL DT with GOF 66x42

State: 2023-09-11



**BRUNNER**<sup>®</sup>  
*made in germany.*

# Dimension sheets - BSG 01 with MSS

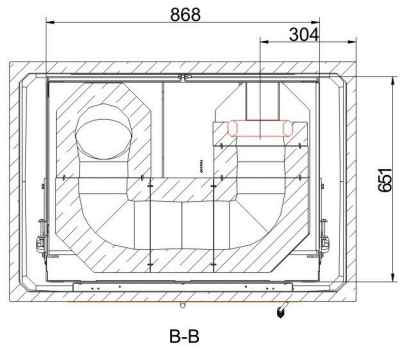
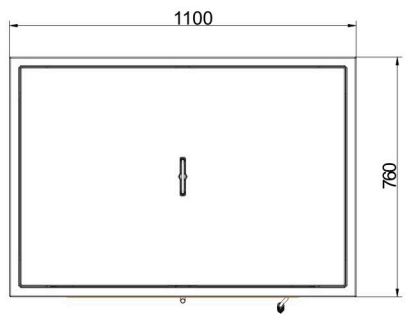
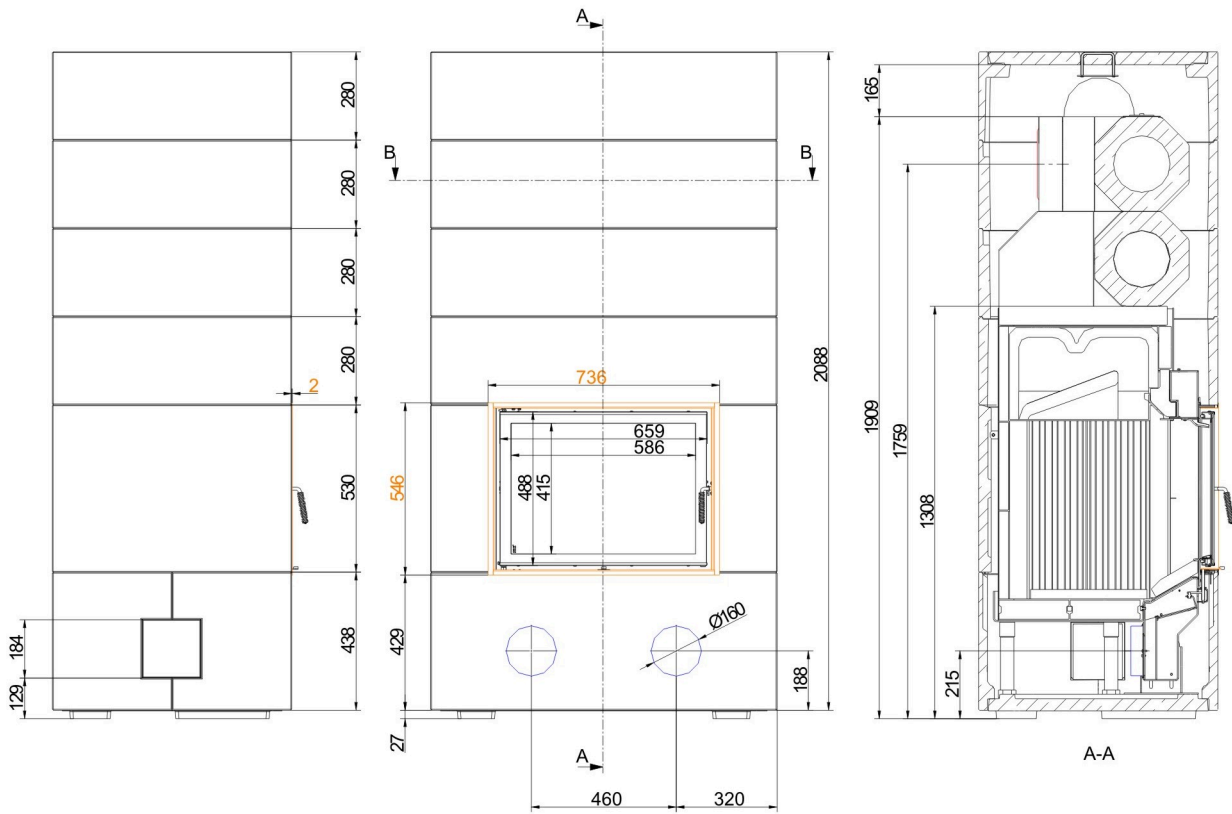

... top-mount

# Dimension sheets - BSG 01 with MSS

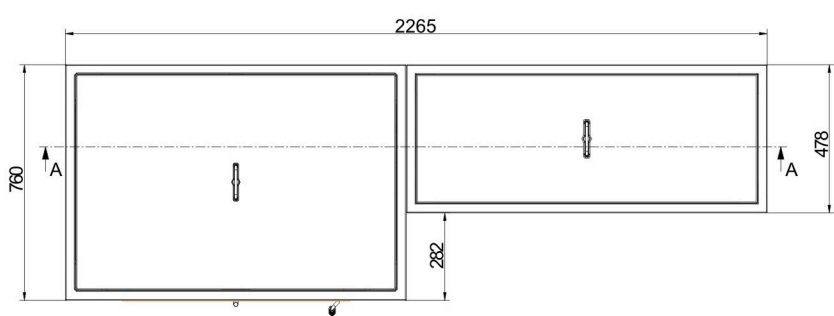
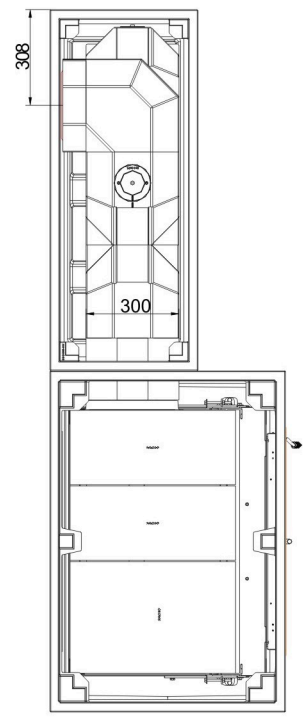
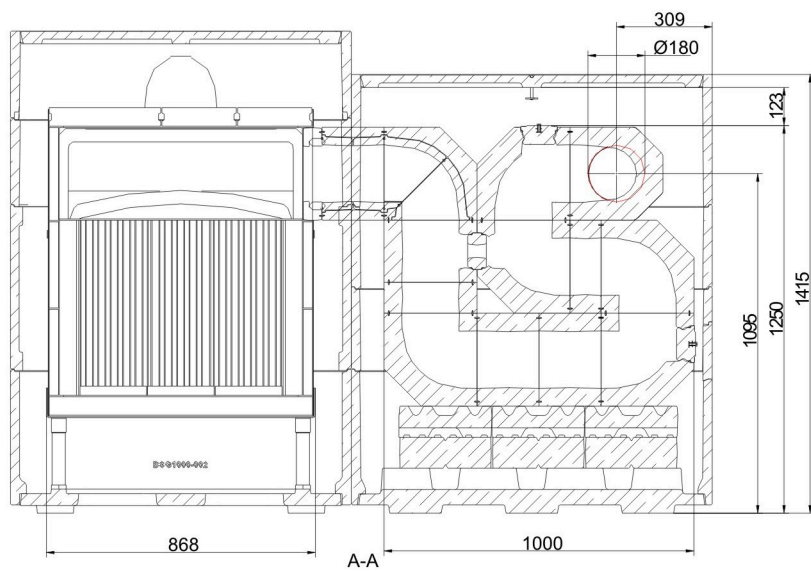
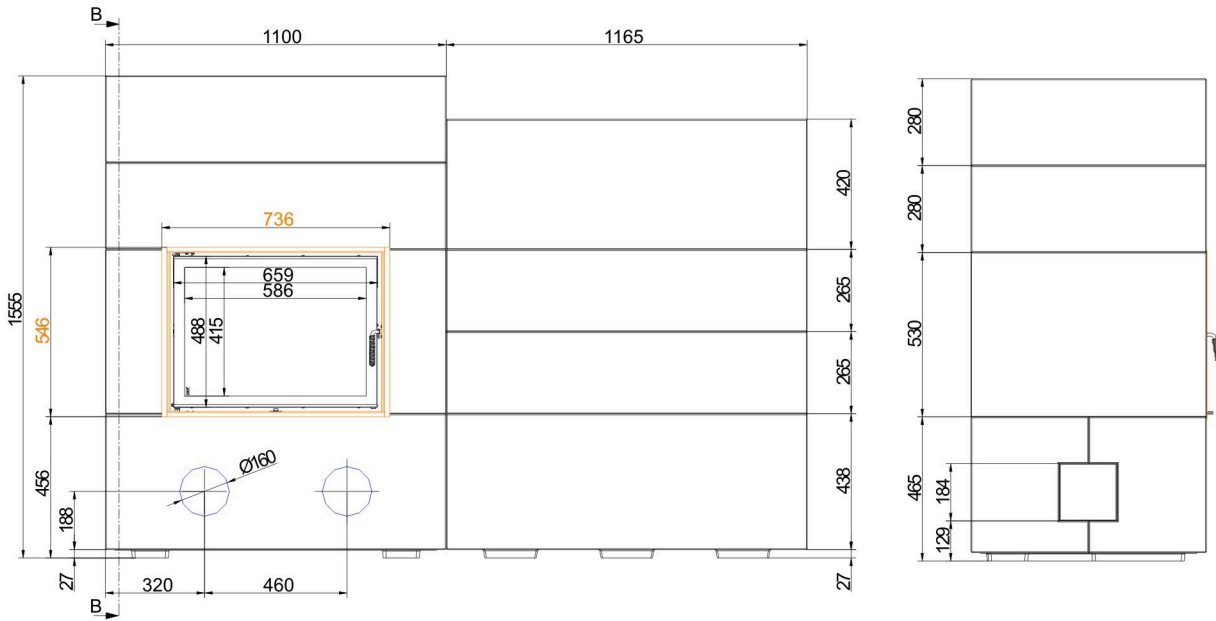

... adjacent

We suggest for CAD planning Palette CAD. Permanent updated drawings: [www.brunner.de](http://www.brunner.de)  
 Frames/ flue gas outlet connection/ combustion air supply connection/ front variants/ support bearing are marked in color.

# Planning and installation - BSG 01 with MSS

Tested according to		EN 15250	EN 15250
Values measured at		top-mount MSS	adjacent MSS
<b>Data for functional demonstration</b>			
System power <sup>1)</sup>	kW	2.2	2.8
Fire wood volume	kg/h	7.9	8.3
Combustion duration	h	2	2
Time of heat release <sup>2)</sup>	h	12	12
Combustion performance	kW	31.6	33.2
Flue gas mass flow	g/s	24.4	25.5
Outlet temperature (before reheating surface)	°C	550	550
Flue gas temperature after:			
accumulation stones (MSS)	°C	195	190
Necessary supply pressure	Pa	13	13
Total fuel load	kg	12	17
Load of wood 1st/2nd combustion cycle	kg	8 + 4	9 + 8
Combustion air consumption	m <sup>3</sup> /h	71	74
Combustion air connection Ø	mm	160	160
<b>Minimal distances</b>			
to mounting wall	cm	5	5
to combustible mounting wall	cm	10	10
from top of fireplace to ceiling	cm	30	30
<b>Heat distribution</b>			
Insert / reheating surface	%	30 / 50	30 / 50
Glass pane (single / double)	%	- / 20	- / 20
<b>Weight</b>			
Combustion chamber / accumulator	kg	520 / 298	520 / 332
Cladding <sup>3)</sup>	kg	443	734
Total weight	kg	1261	1586
<b>Meets requirement/limit values for:</b>			
Germany/ Austria / Switzerland / Norway		1.BImSchV (Stufe 2) / 15a BVG (2015) / LRV / -	

- 1) Average heating power of the system (heat storage duration) with load of wood 1st/2nd combustion cycle
- 2) Time from firing star to reaching 25% of the maximum surface temperature against the room temperature
- 3) Quality features of the cladding components in concrete look (fair-faced concrete class 2-3)

#### **Dimensional tolerances of the casting mold parts**

Straightness: +- 2 mm/m

Length/width/thickness: +- 2 mm

Squareness: +- 2 mm

Flatness: +- 2,5 mm

#### **Surface to visible side**

Textur: closed and largely uniform; repair areas with color changes and hairline cracks permissible.

Porosity: max. three holes with diameter <10 mm and depth <10 mm (reference area 100x100 mm).

Colour shade: uniform, large-area light/dark discolouration and cement haze permissible; no rust and dirt spots as well as different bulk layers.

**Note:** deviations in color tone (e.g. extension rings) can be adjusted by applying a glaze-like paint (our recommendation: DecoLasur Matt tinted in the colour shade Schiefer16, Caparol).

With the BRUNNER revision set (Art. No. 900300), touch-up work can be carried out on the cladding components.