

TILE STOVE INSERTS FROM BRUNNER



HKD 4.1

State: 2023-08-29



BRUNNER[®]
made in germany.

Dimension sheets - HKD 4.1

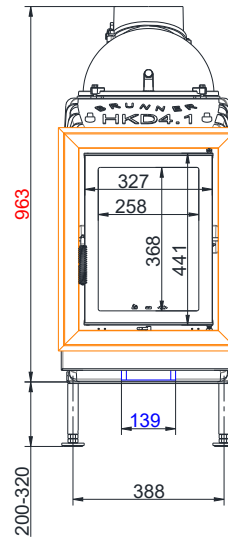
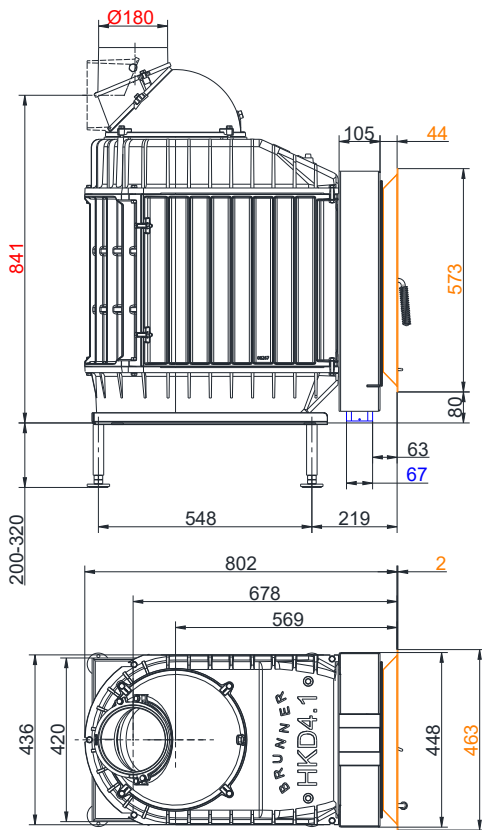

... with steel door frame

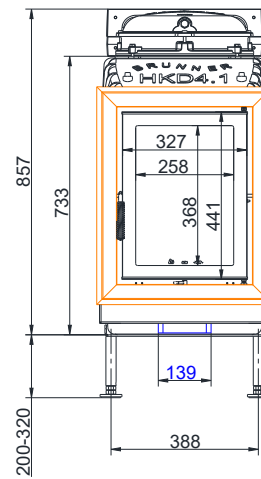
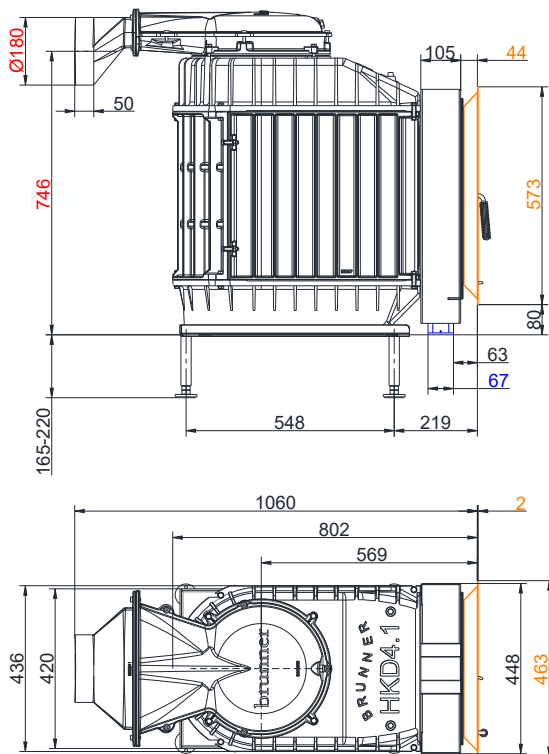

... with steel door frame

Dimension sheets - HKD 4.1

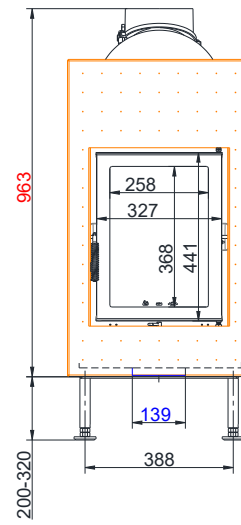
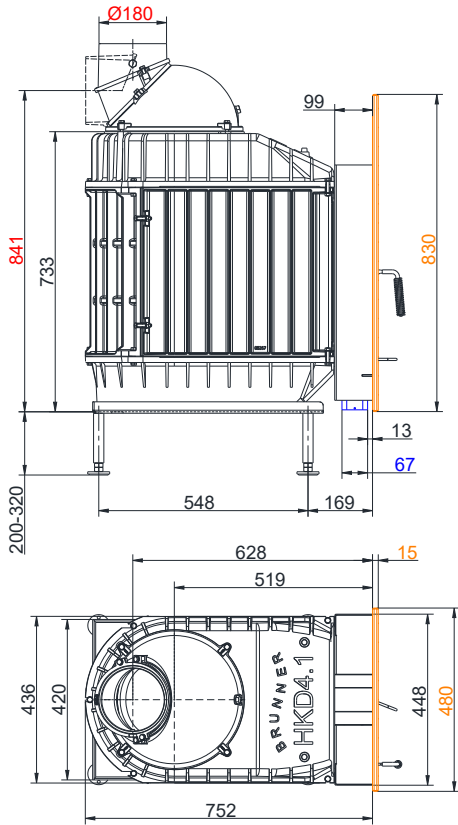

... with steel front plate

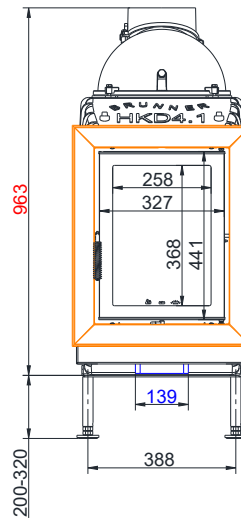
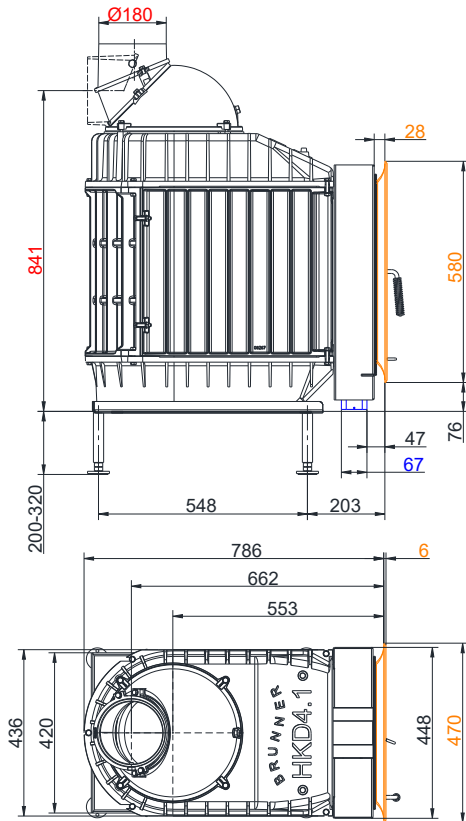

... with cast iron frame

Dimension sheets - HKD 4.1

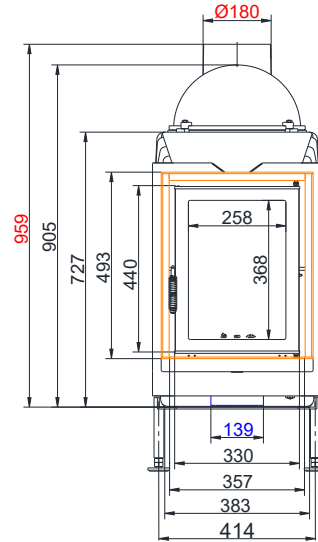
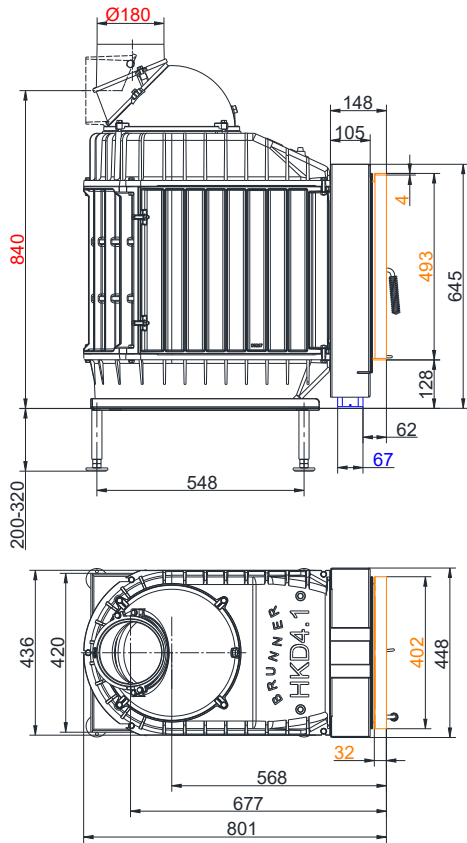

... with mounting frame

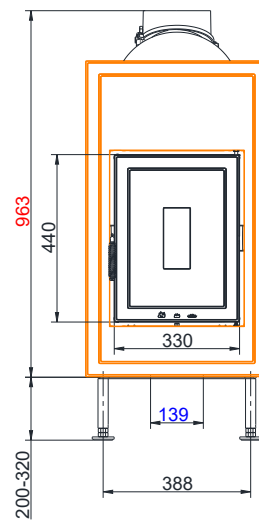
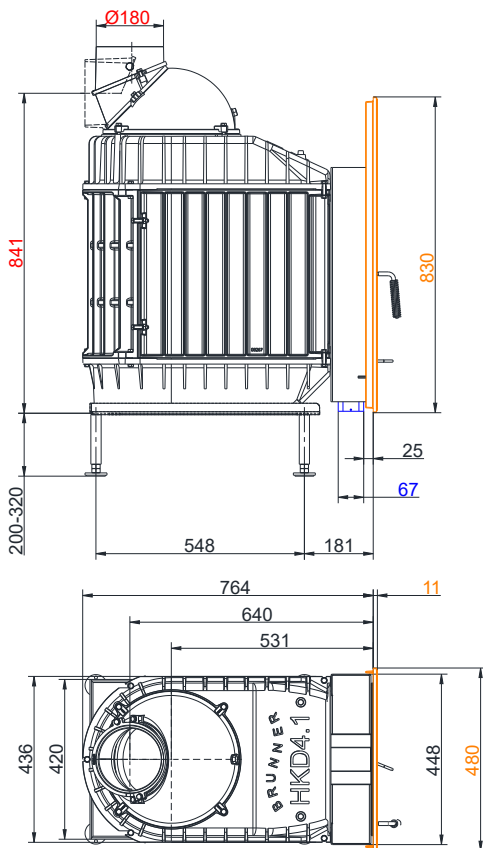

... with cast iron front plate

Dimension sheets - HKD 4.1

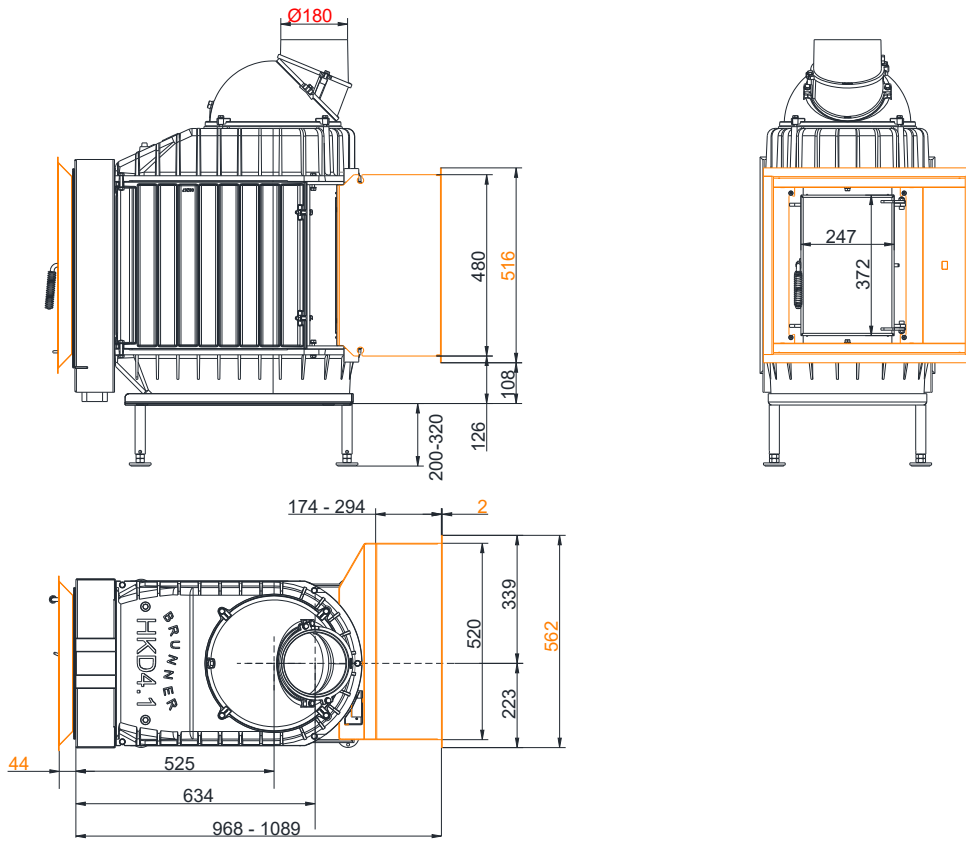

... with additional fire door

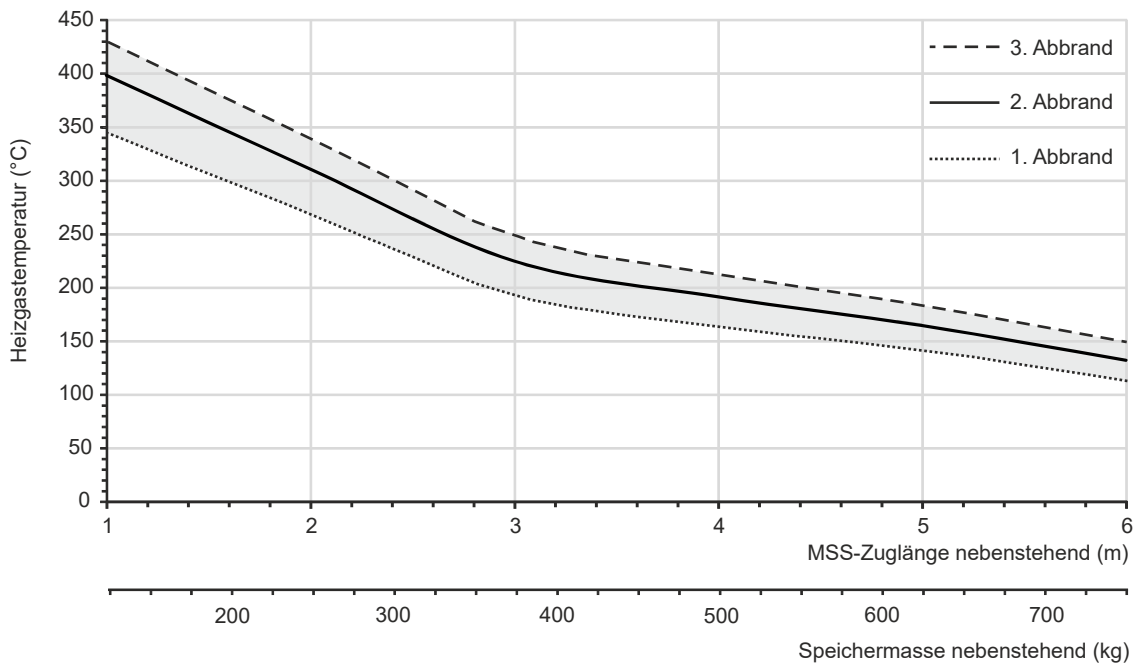

We suggest for CAD planning Palette CAD. Permanent updated drawings: www.brunner.de
 Frames/ flue gas outlet connection/ combustion air supply connection/ front variants/ support bearing are marked in color.

Planning and installation - HKD 4.1

Tested according to		EN 13229 W	EN 13229 WA
Values measured at		Rated power ¹⁾	Storage operation ²⁾
Suitable for all construction types according to rules		OK	OK
Data for functional demonstration			
Rated heat power	kW	11	-
Fire wood volume	kg/h	3	5.5
Combustion performance	kW	13	23
Flue gas mass flow	g/s	13	20
Outlet temperature (before reheating surface)	°C	510	620
Flue gas temperature after:			
2 x adjoining cast iron radiator (GNF 8/10)	°C	140	160
4,9 m ceramic accumulator ³⁾	°C	-	180
3,4 m accumulation stones (MSS) ³⁾	°C	-	210
Necessary supply pressure	Pa	15	15
Combustion air consumption	m ³ /h	35	60
Combustion air connection Ø	mm	125	125
Heating gas temperature (before the hood/dome variant)			
insert flue outlet nozzle	°C	510	620
Heat distribution			
Insert / reheating surface	%	45 / 45	45 / 45
Glass pane (single / double)	%	- / 10	- / 10
Cross-section of gratings ⁴⁾			
Convection air	cm ²	750 / 250 / 1000	750 / 250 / 1000
Supply air	cm ²	750 / 250 / 1000	750 / 250 / 1000
Minimal distances of the fireplace			
to cladding, insulation layer	cm	8	8
to mounting floor	cm	15	15
Thermal insulation without / with air gratings ⁵⁾			
Mounting wall	cm	12 / 9	12 / 9
Floor	cm	0	0
Ceiling	cm	25 / 18	25 / 18
Isolation around the additional door		6	6
Brick lining for combustible wall	cm	10	10
Weight			
Fireplace / combustion chamber	kg	145 / 96	
Meets requirement/limit values for:			
Germany/ Austria / Switzerland / Norway		1.BImSchV (Stufe 2) / 15a BVG (2015) / LRV / -	

- 1) Indications to "Rated power" determined with metallic reheating surface
- 2) Indications to "Storage operation" for the manual execution of the reheating surface (guide values).
- 3) Approximate value. Determination according to design characteristics for adjacent storage mass or proof of function provided by calculation
- 4) for fireplace inserts / flue gas pipe / metallic reheating surface
- 5) Values determined with air cross-sections evaluated by testing; stove cladding is heat emitting.